

# VA2050 3" Emergency Valve

VA1050 (Grooved Style) Parts are Interchangeable

PARTS BREAK DOWN

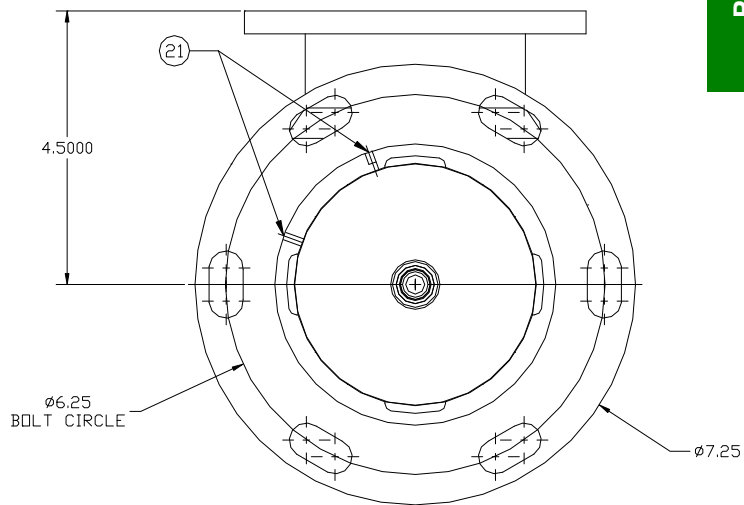
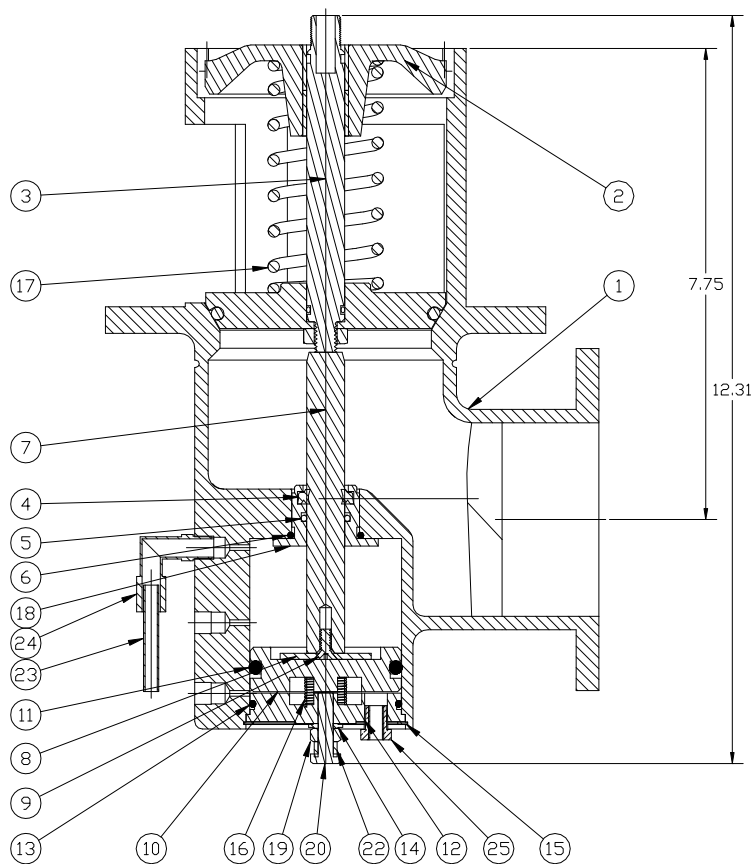

ITEM	PART NUMBER	DESCRIPTION	QTY.
1	11243	MACHINED BODY	1
2	10819	TOP CAP ASSEMBLY	1
3	10810M	POPPET SUB-ASSEMBLY	1
4	10238M	WIPER SEAL	1
5	10681M	O-RING, VITON GF	1
6	10700	O-RING, VITON GF	1
7	10692	ROD, SS	1
8	10338	WASHER	1
9	10339	SCREW, 10-24 x 1/2 18-8	1
10	10683	PISTON	1
11	10676M	O-RING, FLUROSILICONE	1
12	10719	END CAP	1
13	10720	O-RING, BUNA-N	1

ITEM	PART NUMBER	DESCRIPTION	QTY.
14	10344	SEAL WASHER, 1/4" SS	1
15	10345	RETAIN CLIP	1
16	10346	SPRING, POPPET	1
17	10347	SPRING, AIR CYLINDER	1
18	10823	GLAND NUT	1
19	1088	NUT, 1/4-20 18-8	1
20	9541	SCREW, 1/4-20 x 1 18-8	1
21	9760	PIN, SS	2
22	10746	JACK SCREW	1
23	9052	QUICK EXHAUST	1
24	9054	BRASS ELBOW	1
25	5047	FUSIBLE PLUG	1



## REPAIR PROCEDURE

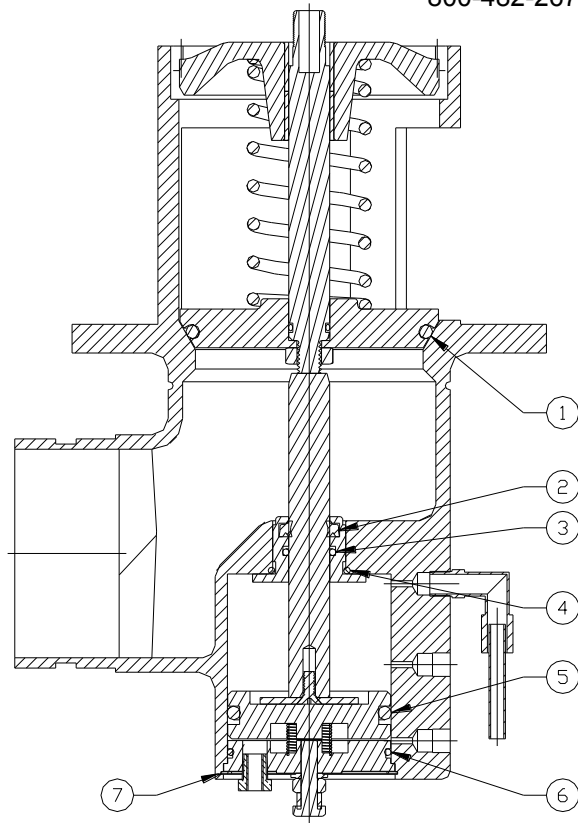

Figure 1 - 3" Emergency Valve Section View

## BILL OF MATERIAL

ITEM	PART NUMBER	DESCRIPTION	QTY
1	11278M	O-Ring, Tef-O-Sil, supplied with 12455	1
1	10680M	O-Ring, Viton GF, supplied with 12454	1
2	10238M	Wiper Seal	1
3	10681M	Internal Gland O-Ring	1
4	10700	External Gland O-Ring	1
5	10676M	Fluorosilicone O-Ring	1
6	10720	End Cap O-Ring	1
7	10345	Retaining Ring, SS	1
8	12244	Silicone Lubricant	1

1. Review Figure 1 before disassembling the valve
2. Remove retaining ring (7). This will allow the bottom cap to then be removed.
3. Remove spring, piston, and shaft. Remove gland nut with 1 1/2" socket.
4. Remove wiper seal (2) and o-rings (3) & (4) from inside and outside of gland nut and replace with new o-rings from kit.
5. Apply lubricant (8) to wiper seal (2), internal gland o-ring (3), external gland o-ring (4), and shaft.
6. Reinstall gland nut with 1 1/2" socket, then the shaft.
7. Remove blue fluorosilicone o-ring (5) from piston being careful not to scratch the o-ring groove, and replace with new o-ring from kit.
8. Remove end cap o-ring (6), being careful not to scratch o-ring groove, and replace with new o-ring from kit.
9. Apply lubricant (8) to fluorosilicone o-ring (5), end cap o-ring (6), and bore. Re-install piston, spring, cap and retaining ring (7).
10. Push down on top cap and rotate clockwise until it stops. Slowly release pressure on the cap and remove it from the assembly.
11. Remove spring and poppet. Remove poppet o-ring (1), being careful not to scratch the o-ring groove, and replace with new o-ring from kit.
12. Reinstall poppet into valve along with spring.
13. Reinstall top cap onto valve by compressing cap and turning counter-clockwise until tabs on cap slide into their locking slots
14. Test valve to verify proper operation. Activate the valve with an air supply (80 psi minimum). Actuate the valve several times to ensure proper operation. With valve open, submerge entire valve in clear water. Wait 20 seconds and check for air bubbles. Air bubbles would indicate a leak and further repair would be required.

## ORDERING SPECIFICATIONS

### 3" Emergency Valve Seal Repair Kit

**12454 Seal Repair Kit (Viton)**

**12455 Seal Repair Kit (Tef-O-Sil)**